



Lake Grace Shire Hall
PO Box 50 Lake Grace 6353
T 08 9890 2500

Exterior photos



Front entrance



Rear side loading door and ramp

General Description

Beautifully maintained older style sports gymnasium with a 900mm high proscenium arch stage. A single 30-amp three-phase power supply is conveniently located backstage right. Estimated concert style capacity of 350.

LAKE GRACE SHIRE HALL - FLOORPLAN

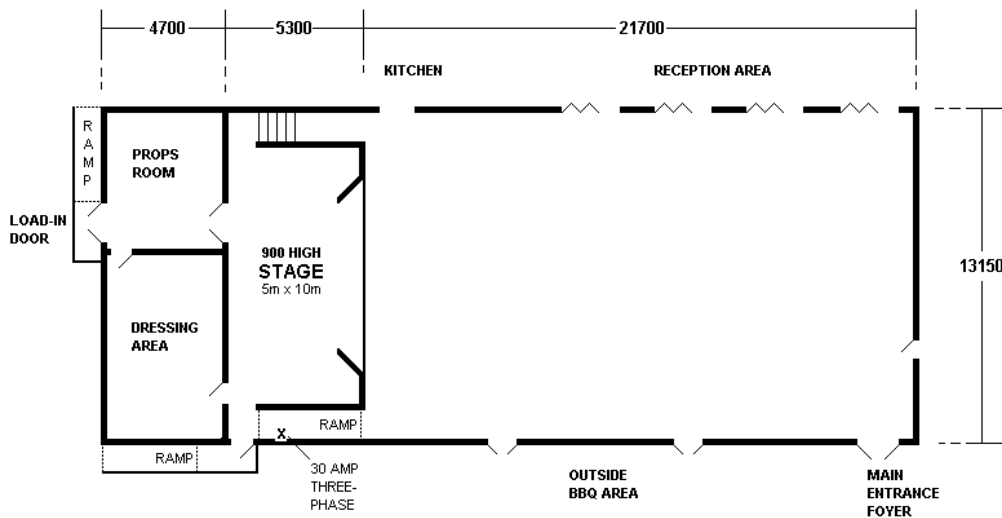

Touring Tips

An acoustic nightmare; bring plenty of black wool tabs, trees and trussing, and try to fence your audience into as small an area as possible.

There are only two 10-amp outlets servicing the stage and the auditorium, both are located directly in front of the stage; if you need more power you'll have to run extensions from the kitchen.

There are no positions to hang lights from. You'll need winch-ups for front of house. There is a 75mm squared length of steel, running directly behind the proscenium arch that you could chain a scaffold bar or truss to.

There are no plumbing facilities backstage.

Interior photo



Lake Grace Shire Hall - stage floorplan

X = 30amp three-phase o = 10 amp

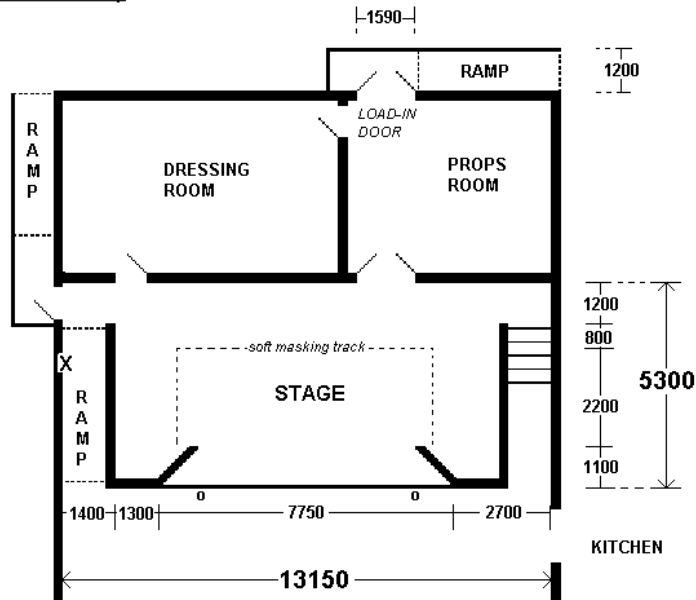

Dimensions

Stage depth	5300
Stage width	13150
Stage height	900
Stage thrust	1100
Stage floor to ceiling	4570
Stage floor to lx bars	3640
Proscenium width	6215
Proscenium height	3190
Auditorium depth	21700
Auditorium width	13150
Aud floor to ceiling	5400 @ centre
Aud floor to lx bars	N/a

Flying facilities

Flying system	None
Masking	Lightweight peach cotton; 2000 from upstage wall.
Cyclorama	No

Lighting facilities

3 phase power and location	30 amp three-phase dsr
Operating position (s)	None
Lighting desk	
Dimmers and location	No
Wired lighting bars number of	No

circuits and locations	
Patching facilities	No
Lamp stock	None
Alternative onstage lighting positions	There is a 100 x 40 timber beam on the ceiling, 2000 down from the upstage wall that would probably support a 150kg bar by wire. There are a few hooks and eyes screwed into various roof support beams
Alternative front lighting positions	There is a serious timber joist 2750 in front of stage that has fittings for an lx bar. Talk to shire in advance.
Type of ceiling/ Possible fixing points	Timber and plaster
Blackout	No. Three windows along the side auditorium, and one on stage right.
Ladders	
Onstage 10amp outlets	None. There are two power points on the front of the stage thrust
Aud 10amp outlets	As above
Houselights	None on dimmer
Working lights	Fluorescents

Sound facilities

Operating position (s)	None
Sound desk	Basic sound system available through shire
Amplifiers	
Speakers	
Foldback	
Microphones	
Mic stands	
Cd or cassette players	
Sends	

Communications

Talk-back	
Telephones	
Internet	

Onstage facilities

Crossover	No. Behind upstage tab only
Wing space	Narrow: 1300 each side
Treads to foh	Yes. One set; very heavy with handrails (see interior photo off downstage right).
Ladder	
Rostra	No
Blue worklight	No

FOH facilities

Seating	Plastic chairs
Box office	
Bar	
Kitchen	Y
Toilets	Y
Air conditioning	
Heating	

Backstage facilities

Green room	No
Dressing rooms	Two large room backstage
Toilets	None backstage
Showers	N
Mirrors	N
Laundry	
Ironing	

Bump-in access

Load-in description	Tricky: plenty of room to manoeuvre a truck but there is a 1:3 gradient ramp. It is 3600 long x 1200 wide and ends 1200 high but it is side-on to the double door. You then have to travel 4700 through the props room to get to the back of the stage. There are narrower 1200 wide doors entering onto the side of the auditorium, but you have to travel over grass.
Loading door size	1590w x 1970h double door
Exterior lighting	No
Parking	Lots
Storage	Large props area backstage

Emergency systems

Smoke alarms	
Sprinkler systems	
Fire extinguishers	Yes
Fire hoses	
Emergency exits	Yes
Exit signs	Yes
Medical contact	000

Pre-sales

Ticketing system	
Advertising positions	

Posters/banners	
Local publications	
Local radio	
Word of mouth	

Friendly neighbours

Doctor	
Hardware	
Publican	
Newsagent	
People to inform	